

If you would like more information about the *Map Your Neighborhood* program please contact:

We are OK and have evacuated. Contact us at:

OK

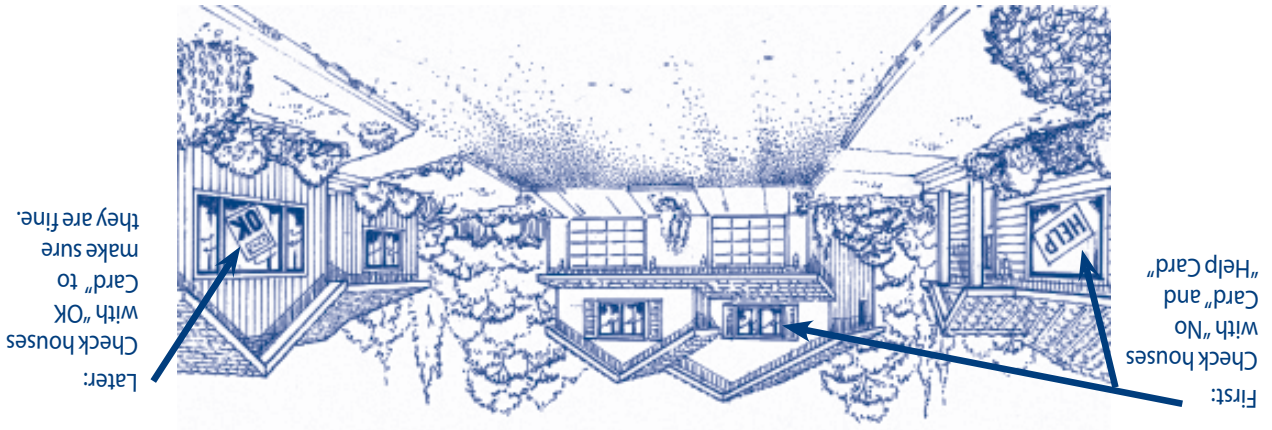

Map Your Neighborhood - MYN

**Neighborhood
Disaster
Readiness**

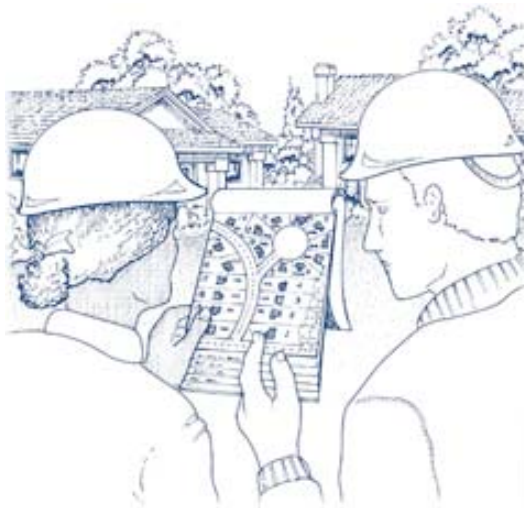

Remember...
Immediately after
disasters, follow the 9
Steps described in this
booklet.



Mar Vista Community Council

www.marvista.org
info@marvista.org



In a disaster, your neighbors are your closest source of help.

In this Handout you will:

- 1. Learn the first 9 Steps to take immediately after a disaster to secure your home and protect your neighborhood.

It is hard to think clearly following disaster. These steps will help you quickly and safely do things that really help.

- 2. Find out the skills and equipment each neighbor has that are useful after a disaster strikes.

Knowing which neighbors have supplies and skills aids your response and allows everyone to help in a meaningful way.

- 3. Create a Neighborhood Map showing the locations of:

- Each natural gas meter and propane tank.

About 67% of house fires following disasters are caused by leaking gas. Knowing where these meters are and shutting them off helps prevent fire.

- Each neighbor who is elderly, disabled, or homes where children may be alone at certain hours of the day.

Checking on neighbors prone to injury helps protect them.

Your neighborhood facilitators are:



BEFORE THE DISASTER
Put two band-aids in this booklet and put the booklet under your bed, along with your sturdy shoes, hard hats, and leather gloves.

AFTER THE DISASTER
Use the band-aids to hang this card on the front door or a window so it is visible from the street.

Used with permission: Washington State Emergency Management / Public Education



Your Neighborhood Contact List (continued)

HOUSE or UNIT 16

Adult Name(s)
Children Name(s)
Best Phone
Email
Pet(s) and kind(s)

Any person with specific needs

HOUSE or UNIT 21

Adult Name(s)
Children Name(s)
Best Phone
Email
Pet(s) and kind(s)

Any person with specific needs

HOUSE or UNIT 26

Adult Name(s)
Children Name(s)
Best Phone
Email
Pet(s) and kind(s)

Any person with specific needs

HOUSE or UNIT 17

Adult Name(s)
Children Name(s)
Best Phone
Email
Pet(s) and kind(s)

Any person with specific needs

HOUSE or UNIT 22

Adult Name(s)
Children Name(s)
Best Phone
Email
Pet(s) and kind(s)

Any person with specific needs

HOUSE or UNIT 27

Adult Name(s)
Children Name(s)
Best Phone
Email
Pet(s) and kind(s)

Any person with specific needs

HOUSE or UNIT 18

Adult Name(s)
Children Name(s)
Best Phone
Email
Pet(s) and kind(s)

Any person with specific needs

HOUSE or UNIT 23

Adult Name(s)
Children Name(s)
Best Phone
Email
Pet(s) and kind(s)

Any person with specific needs

HOUSE or UNIT 28

Adult Name(s)
Children Name(s)
Best Phone
Email
Pet(s) and kind(s)

Any person with specific needs

HOUSE or UNIT 19

Adult Name(s)
Children Name(s)
Best Phone
Email
Pet(s) and kind(s)

Any person with specific needs

HOUSE or UNIT 24

Adult Name(s)
Children Name(s)
Best Phone
Email
Pet(s) and kind(s)

Any person with specific needs

HOUSE or UNIT 29

Adult Name(s)
Children Name(s)
Best Phone
Email
Pet(s) and kind(s)

Any person with specific needs

HOUSE or UNIT 20

Adult Name(s)
Children Name(s)
Best Phone
Email
Pet(s) and kind(s)

Any person with specific needs

HOUSE or UNIT 25

Adult Name(s)
Children Name(s)
Best Phone
Email
Pet(s) and kind(s)

Any person with specific needs

HOUSE or UNIT 30

Adult Name(s)
Children Name(s)
Best Phone
Email
Pet(s) and kind(s)

Any person with specific needs

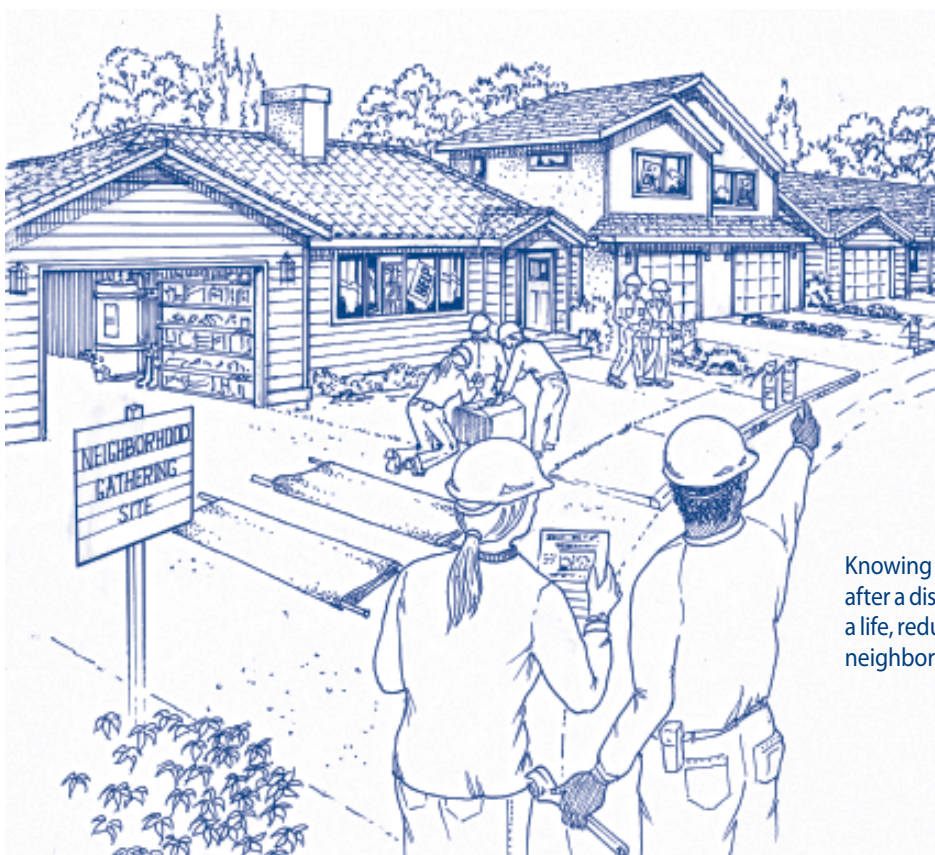

Knowing what to do in the first hours after a disaster may help you save a life, reduce injury, and decrease neighborhood damage.

9 Steps — Immediately Following Disaster

AT HOME...

- Step 1. **Take care of your loved ones.**
- Step 2. **Dress for safety.** A bicycle helmet or hard hat protects from falling debris. Sturdy shoes protect from broken glass. Leather gloves protect from sharp objects.
- Step 3. **Check the natural gas or propane at your home.** Shut off if necessary. This is one of the best ways to prevent fire.
- Step 4. **Shut off water at the house main** to trap water in your home. This will keep pollutants out of possible drinking water, like that in your water heater.
- Step 5. **Place the Help or OK sign** (see back page) on your front door or window. Posting the sign helps your neighbors locate those who need help first.
- Step 6. **Put your fire extinguisher on the sidewalk** or where neighbors can see it. This way, if a neighbor has a small fire after a disaster, extinguishers are on hand.

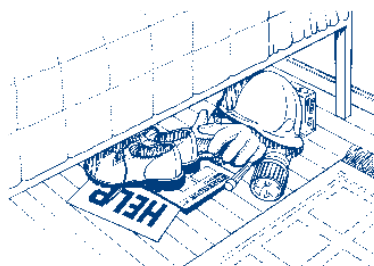

Step 2: Keep these under your bed.

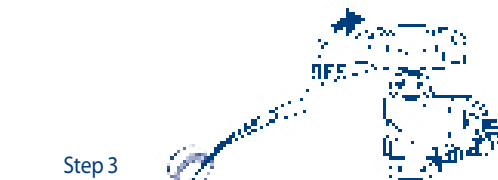

Step 3

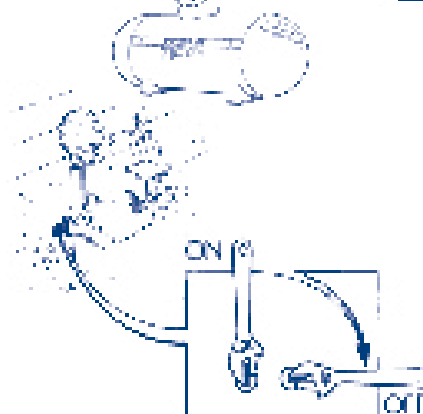

Turn the valve 1/4 turn to shut off the gas. NEVER turn it back on once it has been turned off.

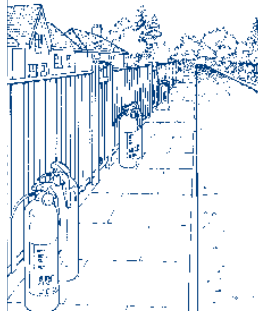

Step 6

Your Neighborhood Contact List (may continue on next page)

HOUSE or UNIT 1

Adult Name(s)
Children Name(s)
Best Phone
Email

Pet(s) and kind(s)

Any person with specific needs

HOUSE or UNIT 6

Adult Name(s)
Children Name(s)
Best Phone
Email

Pet(s) and kind(s)

Any person with specific needs

HOUSE or UNIT 11

Adult Name(s)
Children Name(s)
Best Phone
Email

Pet(s) and kind(s)

Any person with specific needs

HOUSE or UNIT 2

Adult Name(s)
Children Name(s)
Best Phone
Email

Pet(s) and kind(s)

Any person with specific needs

HOUSE or UNIT 7

Adult Name(s)
Children Name(s)
Best Phone
Email

Pet(s) and kind(s)

Any person with specific needs

HOUSE or UNIT 12

Adult Name(s)
Children Name(s)
Best Phone
Email

Pet(s) and kind(s)

Any person with specific needs

HOUSE or UNIT 3

Adult Name(s)
Children Name(s)
Best Phone
Email

Pet(s) and kind(s)

Any person with specific needs

HOUSE or UNIT 8

Adult Name(s)
Children Name(s)
Best Phone
Email

Pet(s) and kind(s)

Any person with specific needs

HOUSE or UNIT 13

Adult Name(s)
Children Name(s)
Best Phone
Email

Pet(s) and kind(s)

Any person with specific needs

HOUSE or UNIT 4

Adult Name(s)
Children Name(s)
Best Phone
Email

Pet(s) and kind(s)

Any person with specific needs

HOUSE or UNIT 9

Adult Name(s)
Children Name(s)
Best Phone
Email

Pet(s) and kind(s)

Any person with specific needs

HOUSE or UNIT 14

Adult Name(s)
Children Name(s)
Best Phone
Email

Pet(s) and kind(s)

Any person with specific needs

HOUSE or UNIT 5

Adult Name(s)
Children Name(s)
Best Phone
Email

Pet(s) and kind(s)

Any person with specific needs

HOUSE or UNIT 10

Adult Name(s)
Children Name(s)
Best Phone
Email

Pet(s) and kind(s)

Any person with specific needs

HOUSE or UNIT 15

Adult Name(s)
Children Name(s)
Best Phone
Email

Pet(s) and kind(s)

Any person with specific needs

Your Neighborhood Map

Draw the layout of streets, building lots and houses (see previous "Guidelines for Neighborhood Mapping"). Number building lots in order. Mark exact locations of gas meters and propane tanks.



WITH NEIGHBORS...

Step 7. **After Steps 1-6 are completed, go to the Neighborhood Gathering Site.** (The following page will help you choose this location.)

Write your Neighborhood Gathering Site location here:



Step 8. Form Teams at the Neighborhood Gathering Site:

- Team 1 will listen to the Emergency Alert System (AM/FM radio), or to a NOAA Weather Radio and keep neighbors informed of what they learn.
- Team 2 will check on neighbors who are elderly, those disabled, or homes where children may be alone.
- Team 3 will check all natural gas meters and propane tanks, and shut off the gas as necessary.
- Team 4 will check on all homes with the "Help" card displayed on the front door or window, or with no card showing. Be prepared to give first aid. Trust your instincts. If something feels unsafe, stay out.

Step 9. After your Team has completed its work, go back to the Neighborhood Gathering Site. Share what you have done with the rest of your neighbors.

Your neighborhood leader will report the status to:

Contact information:

Neighborhood Gathering Site and Care Center

Neighborhood Gathering Site:

Come to the Neighborhood Gathering Site after you have finished Steps 1-6. This will help you organize and reduce confusion.

The Neighborhood Gathering Site is in a protected area that it is easily seen. The visibility will help remind everyone that they should come here. An open garage, porch or carport would work well and protect you from the elements. Stay clear of power lines and damaged structures.

Write your Neighborhood Gathering Site here (please also write this location in the box on the previous page):

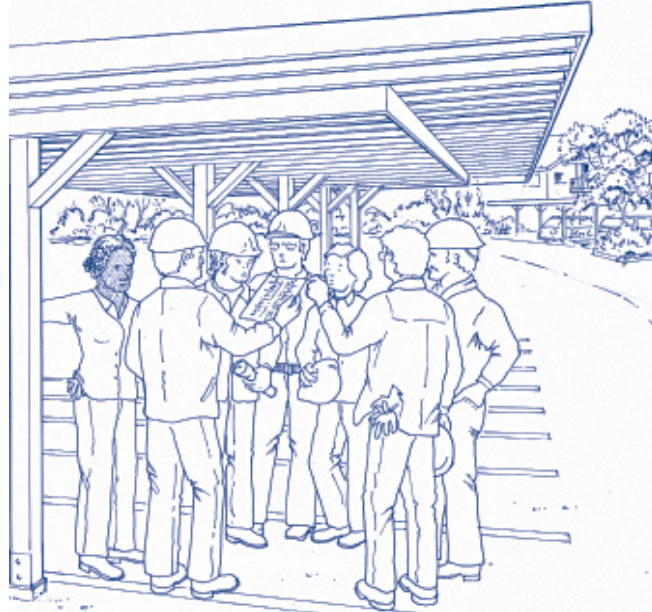

FOURTH:

- In the tinted box on the Contact List, write names of those who may need extra help during disasters. For example, neighbors who are elderly, those with a disability, or homes where children may be alone.
- Match **1** on contact list with the lot that you numbered "1," match **2** with the lot that you numbered "2," match **3** with "3," match **4** with "4," etc.

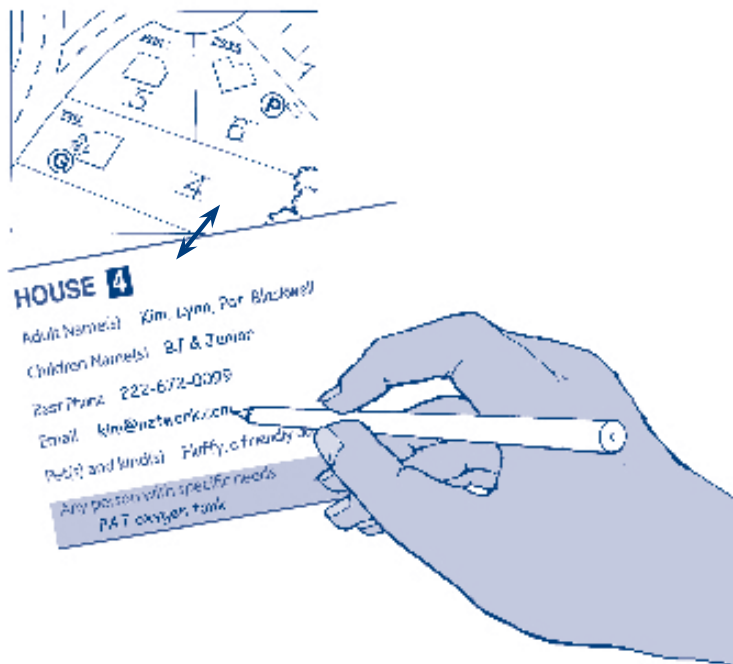

In the next 48 hours, complete the Contact List as shown above.

Guidelines for Neighborhood Mapping

These guidelines will help you sketch a neighborhood map (create the sketch on the following page).

FIRST:

Sketch the basic layout of your neighborhood.

- Include streets, building lots, and houses.
- Include house numbers.

SECOND:

Number the building lots in order. This will allow you to easily match each house to the information on the Contact List (see FOURTH step).

THIRD:

Mark the exact location of each natural gas meter or propane tank on your map.

- Explain the location of your gas meter to your neighbors. For example, "behind the lilac bush on the front corner of the house."
- Suggestion: At the end of the meeting, walk your neighborhood and find each meter. It will help to see where each meter is located.

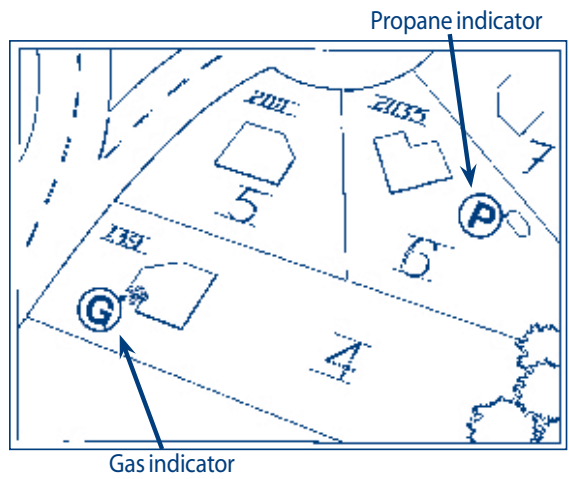
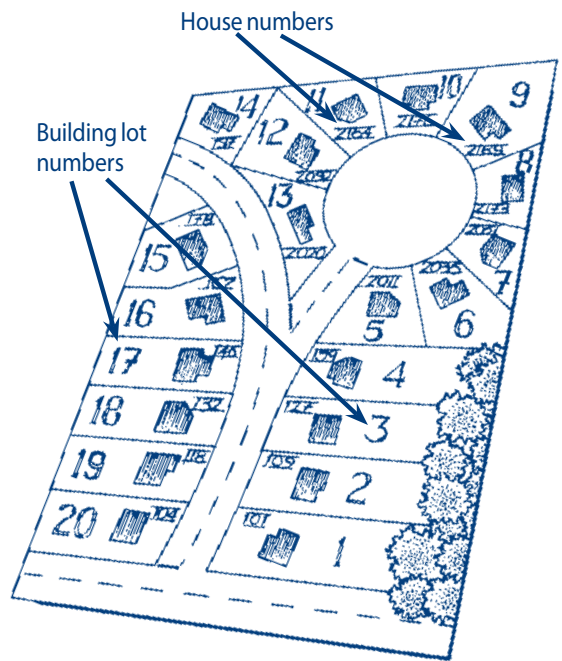

Neighborhood Care Center:

A Neighborhood Care Center is inside someone's home. It is a place where children, those who are elderly and those with disability can be brought so they are not alone and where they can be given care.

Write your Neighborhood Care Center location here:

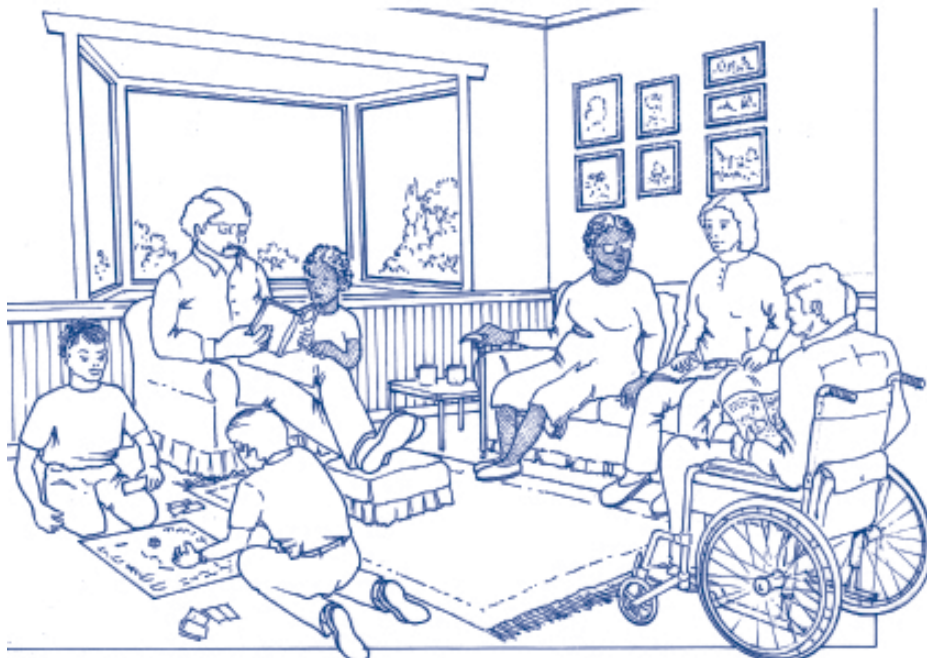

Neighborhood Gathering Site and Care Center

Neighborhood Skills and Equipment Inventory

Who *knows* what? Who *has* what? Who *can do* what?

Write the names of neighbors with these skills/knowledge and equipment/supplies:

SKILLS / KNOWLEDGE	EQUIPMENT / SUPPLIES
First Aid Skills	First Aid Supplies 
Child Care Skills 	Tents / Spare Bedding
Elder Care Skills	Chain Saw
Search and Rescue Skills	Generator
Crisis Counseling Skills	Fire Extinguisher
Plumber Skills	Camp Stove 
Carpenter Skills 	NOAA Weather Radio
Electrician Skills	Walkie-Talkie
Fire Fighting Skills	Ladder
Military/Service Skills	Crow Bar 
HAM Operator	Strong Rope
Language Skills	Lighting
Coordinating and Organizational Skills	